

COMPONENT SPECIFICATION

USE OR REPRODUCTION OF THIS DRAWING FOR THE PURPOSE OF MANUFACTURING THIS ARTICLE OR ANY ARTICLES SHOWN FOR ANY PURPOSE IS STRICTLY PROHIBITED WITHOUT WRITTEN PERMISSION FROM SENIOR INDUSTRIES, INC.

SPECIFICATIONS

ELECTRICAL:

CONTACT RATING: 1.5A AT 125 VAC  
 CONTACT RESISTANCE: 30 MILLIOHMS MAX.  
 INSULATION RESISTANCE: 500 MEGOHMS MIN. AT 500 VDC  
 DIELECTRIC STRENGTH: 1000 VRMS FOR 1 MINUTE

MECHANICAL:

LIFE: 750 CYCLES MIN.

ENVIRONMENTAL:

OPERATING TEMPERATURE: 0°C TO +70°C  
 STORAGE TEMPERATURE: -40°C TO +85°C

MATERIAL:

HOUSING: GLASS FILLED NYLON 66, UL94V-0  
 CONTACT: 0.46mm DIA. PHOSPHOR BRONZE  
 METAL FOOT: 0.50mm THICK BRASS, TIN PLATED  
 TERMINALS: 0.35t PHOSPHOR BRONZE  
 PLATING: CONTACT AREA - SELECTIVE GOLD PLATING OVER NICKEL  
 TERMINATION AREA - 100 μIN TIN OVER NICKEL

PART NUMBER BUILDER:

MODEL	PORTS	CONTACTS	PLATING	METAL FOOT	COLOR
SGJ —					
	2 THROUGH 8	0 = 6 CONTACTS 1 = 4 CONTACTS 2 = 2 CONTACTS		M	1. BLUE 2. RED 3. BLACK 4. BROWN 5. GREEN 6. WHITE 7. GRAY (STD) 8. ORANGE 9. YELLOW 10. VIOLET 11. IVORY/NEUTRAL

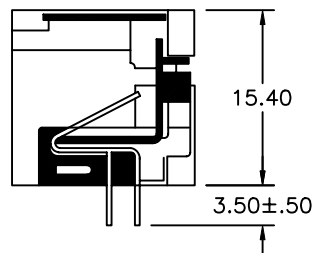
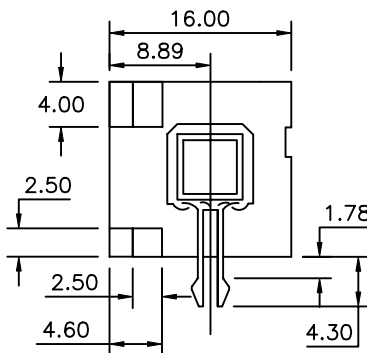
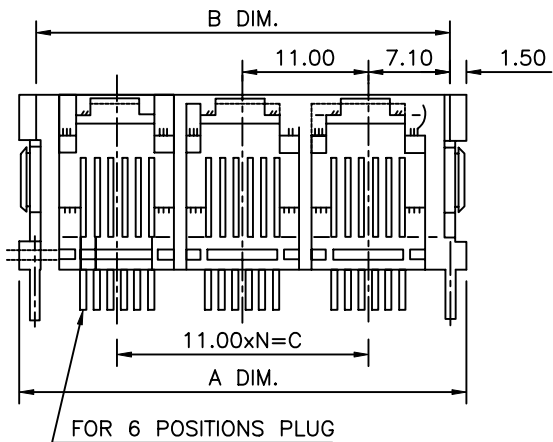

DIMENSION	NO. OF PORT						
	2	3	4	5	6	7	8
A	28.20 1.110	39.20 1.543	50.20 1.976	61.20 2.410	72.20 2.842	83.20 3.275	94.20 3.710
B	25.20 .992	36.20 1.425	47.20 1.860	58.20 2.290	69.20 2.724	80.20 3.157	91.20 3.590
C	11.00 .433	22.00 .866	33.00 1.299	44.00 1.732	55.00 2.165	66.00 2.598	77.00 3.030

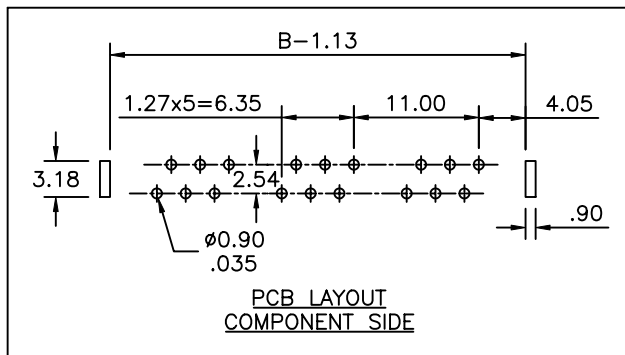

DESIGNED:			SYM.	DATE:	DESCRIPTION OF REVISIONS:	DRAWN:	APPD:
DRAWN:	RJT	02/07/01	▲	02.07.01	NEW	RJT	JF
CHECKED:	GAT	03/01/06	▲	08.15.05	New Index, PN Builder updated, Lead rem'd	KO	JF
APPROVED:	JF	03/01/06	▲				
3RD ANGLE		UNIT:	mm	SCALE:	2:1	REV:	B

TOLERANCE:	PART NO:	SGJ-XX-XX-X
TO 1 DECIMAL PLACE: ±.3	TITLE:	MODULAR JACK
TO 2 DECIMAL PLACES: ±0.15	SHEET:	1 OF 1
AS ANGLES: ±1/2°		

